

Tubes for ring spinning

Dimension and shape accuracy

**WN 425 60-2
EN**

Modifications

In comparison with the edition 05/05 the following modifications have been made: table revised; Tube length 190 added; logo changed

Former Editions

06/97; 02/03; 05/05

Dimension and shape accuracy inspection with tube gauge.

Dimension accuracy in accordance with table 1
Wall thickness S: Recommendation S = 3

Dimensions in mm

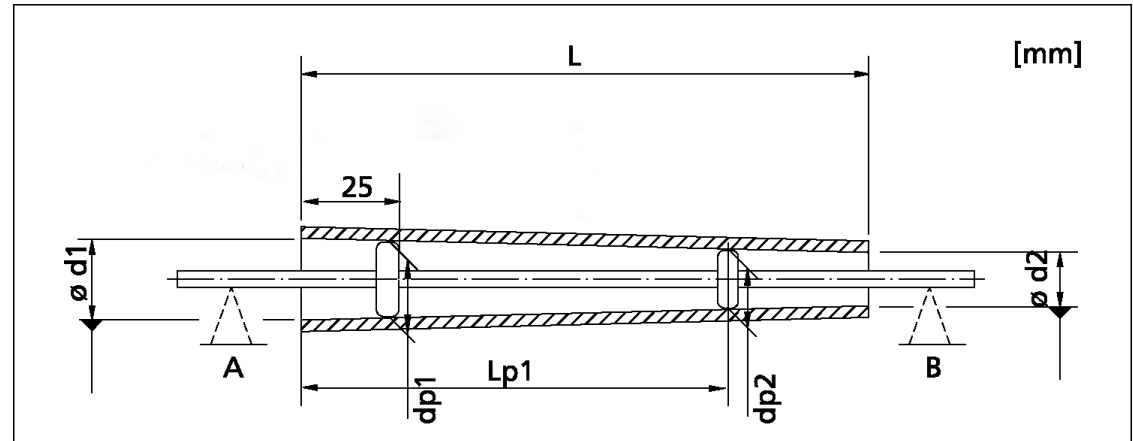

Table 1 Dimensions for tubes with cone 1:38

Length of tubes L	Lp1	Standard series 0				Standard series 1				Standard series 2				Standard series 3				Permissible deviation d
		d1	d2	dp1	dp2	d1	d2	dp1	dp2	d1	d2	dp1	dp2	d1	d2	dp1	dp2	
180±1,5	130	20,24	15,50	19,58	16,82	18,74	14,00	18,08	15,32	17,24	12,50	16,58	13,82	-	-	-	-	±0,08
190±1,5	130	20,24	15,24	19,58	16,82	18,74	13,74	18,08	15,32	17,24	12,24	16,58	13,82					±0,08
200±1,5	130	22,26	17,00	21,60	18,84	20,26	15,00	19,60	16,84	18,76	13,50	18,10	15,34	-	-	-	-	±0,08
210±1,5	130	22,27	16,74	21,61	18,85	20,27	14,74	19,61	16,85	18,77	13,24	18,11	15,35	-	-	-	-	±0,08
220±1,5	160	24,28	18,47	23,62	20,07	22,28	16,49	21,62	18,07	20,28	14,49	19,62	16,07	18,78	12,99	18,12	14,57	±0,08
230±1,5	170	24,30	18,25	23,64	19,83	22,30	16,25	21,64	17,83	20,30	14,25	19,64	15,82	18,80	12,75	18,14	14,33	±0,08
240±2,0	180	27,31	20,99	26,65	22,58	24,31	17,99	23,65	19,58	22,31	15,99	21,65	17,58	20,31	13,99	19,65	15,58	±0,10
250±2,0	180	27,32	20,74	26,66	22,59	24,32	17,74	23,66	19,59	22,32	15,74	21,66	17,59	20,32	13,74	19,66	15,59	±0,10
260±2,0	180	30,34	23,50	29,68	25,60	27,34	20,50	26,68	22,60	24,34	17,50	23,68	19,60	22,34	15,50	21,68	17,60	±0,10
270±2,0	180	30,35	23,24	29,69	25,61	27,35	20,24	26,69	22,61	24,35	17,24	23,69	19,61	22,35	15,24	21,69	17,61	±0,10
280±2,0	180	33,36	25,99	32,70	28,62	30,36	22,99	29,70	25,62	27,36	19,99	26,70	22,62	24,36	16,99	23,70	19,62	±0,10
290±2,0	180	33,37	25,74	32,71	28,63	30,37	22,74	29,71	25,63	27,37	19,74	26,71	22,63	24,37	16,74	23,71	19,63	±0,10
300±2,5	180	36,39	28,50	35,73	31,66	33,39	25,50	32,73	28,66	30,39	22,50	29,73	25,66	27,39	19,50	26,73	22,66	±0,13